

BUILD A SIMPLE COMPOST TOILET

1" = 2.54 cm

1. Start with 4 identical receptacles and a standard toilet seat.

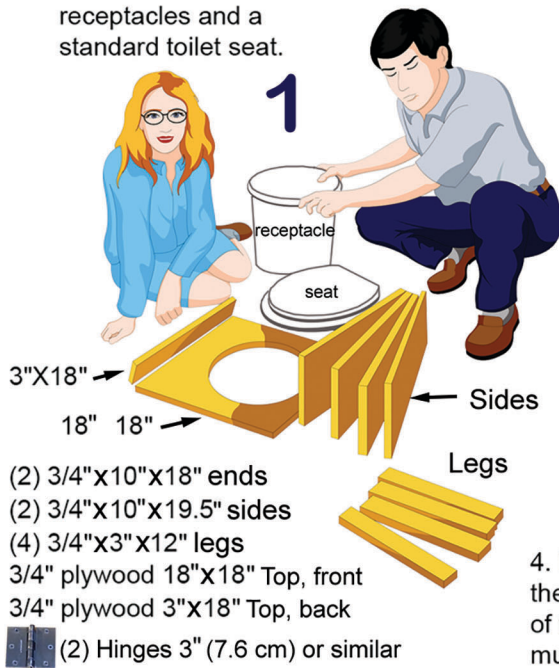

- (2) 3/4"x10"x18" ends
- (2) 3/4"x10"x19.5" sides
- (4) 3/4"x3"x12" legs
- 3/4" plywood 18"x18" Top, front
- 3/4" plywood 3"x18" Top, back
- (2) Hinges 3" (7.6 cm) or similar

2

2. Screw the four boards together.

Finished size = 18"x 21"

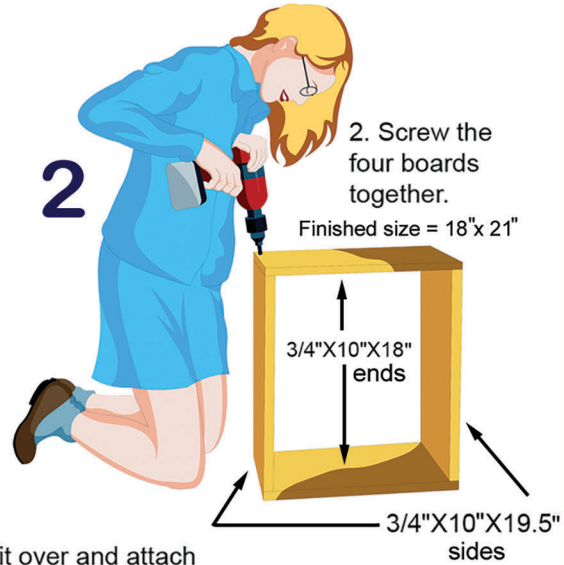

4. Flip it over and attach the four legs to the inside of the box. The receptacle must protrude through the plywood top by about 1/2". Adjust legs accordingly.

3



3. Screw the 3" X 18" board to the box. Leave the 18" X 18" plywood top attached only by the hinges.

4

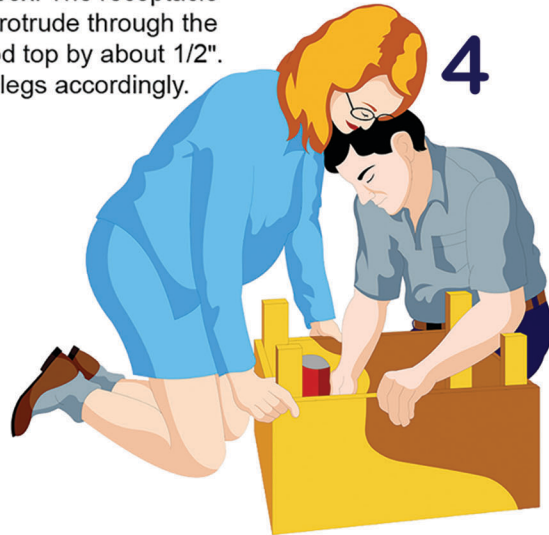

5



5. Swivel the plastic bumpers sideways so the top of the receptacle rim will almost touch the toilet seat ring. The adjusted toilet seat is shown at right. You will have to drill a new hole for each bumper.

Black dots show original holes. Red dots show where the new holes were drilled underneath the bumpers. The holes accommodate the pegs on the underside of the bumpers.

6

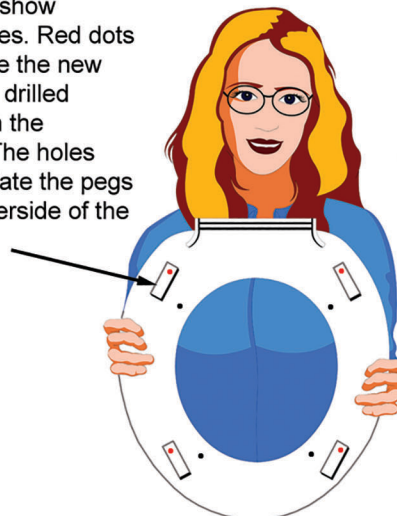



Marking holes for toilet seat.

7



Drilling holes for toilet seat.

8

Mark holes for the toilet seat attachment. A hinged compost toilet cabinet will be 18" wide by 21" long.

Cut the hole in the 18"x18" plywood so it allows the top of your toilet receptacle to fit through it. Set the hole back from the front of the plywood 1.5 inches. These two details are important! Your receptacle must protrude through the plywood top by about 1/2 inch. You adjust this height when you attach the legs. The toilet is built to fit your receptacles, so make sure you have plenty of same-size receptacles.

When screwing the legs to the inside of the box, adjust the height so the receptacle will protrude through the top of the cabinet about 1/2 inch. This allows for a close fit against the toilet seat so all of the toilet material goes down into the toilet and not over the top of the rim. This is why the bumpers were swiveled sideways (to make room for the receptacle rim).

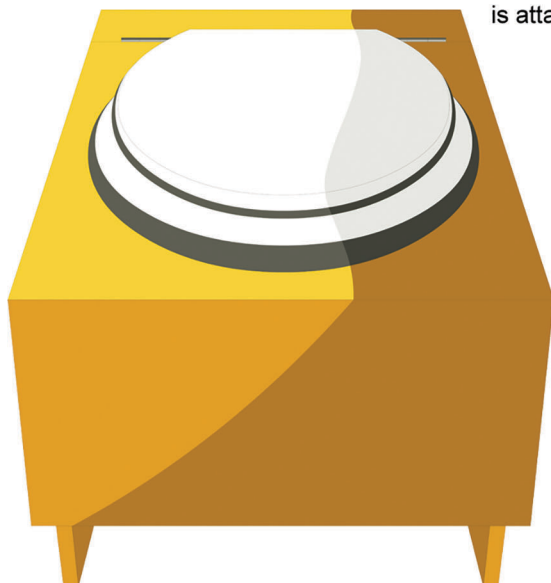

Toilet seat is attached.

9



9. Attach your toilet seat using the two bolts that came with the seat. Stain, varnish, or paint the wood. You now have a compost toilet!